

IT GLITZ

TEACHER'S HANDBOOK



Dear Sir / Madam,

This handbook aims to help the teachers to concentrate more on the practical side. The teachers have to particularly note that in the lower classes especially in the first and second standards, it is meant to give an awareness of the computer and it is not at all necessary to by heart the computer parts or computer related terms. They mustn't feel computer study a burden. Otherwise let them feel enjoyable their studies. It is not mere a computer study but a concrete foundation for their higher studies through the simple basic programming technics.

Thanking You,

Team EDUFY

All rights reserved. No parts of this publication may be reproduced, stored in a retrieval system or transmitted in any form or by any means, electronic, mechanical, photocopying, recording or otherwise, without the prior written permission of the publisher.

STANDARD - 2

SCHEME OF EXAMINATION

TWO TERM SCHEME

BOOKS	TERM I LESSONS	TERM II LESSONS
BOOK 2	1,2,3,4	5,6,7

THREE TERM SCHEME

BOOKS	TERM I LESSONS	TERM II LESSONS	TERM III LESSONS
BOOK 2	1,2,3	4,5	6,7

Note: Questions for each terminal examination cover only the portions prescribed for it.

I Multiple choice questions

- 1) Smart classroom 2) Scanning 3) Emigration 4) ATM

II Fill in the blanks

- 1) Play Game 2) Keyboard, Mouse, Monitor, CPU 3) CD/DVD drive
4) Scan

III Identify the parts of a computer

- 1) Scanner 2) Joystick 3) Pen drive 4) Printer

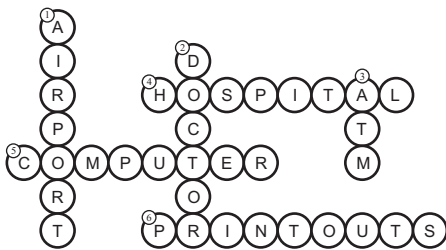
IV Fill the crossword**V True or false**

- 1) True 2) False 3) True

VI Match the following

- 1) Hospital 2) Designing 3) Office 4) Home 5) Railway Station

VII Find out and round the given words in the letter grid

Q	B	M	O	U	S	E	P
C	O	M	P	U	T	E	R
H	O	R	A	M	T	J	I
B	K	T	Q	K	G	N	N
A	S	Y	S	H	O	P	T
N	P	H	O	M	E	B	I
K	D	E	S	I	G	N	N
A	I	R	P	O	R	T	G
S	R	A	I	L	W	A	Y

VIII Connect with related features

- Bank (5,6) Home (2,1) School (4,3)

IX Identify the places

- 1) Textiles 2) Hospital 3) Printing 4) School 5) Home 6) Bank

I Rearrange the steps to switch ON a computer

- 1) Turn On Main Supply 2) Turn On UPS 3) Turn On CPU 4) Turn On Monitor

II Arrange the block in the right order to get names of electronic devices

- 1) Mainframe 2) Television 3) Desktop 4) Palmtop

III Number the device according to their size



IV Rearrange the steps to switch OFF a computer

- 1) Start Button 2) Power Button 3) Shut down button 4) Power of monitor
5) Power of UPS 6) Power off Main supply

V Connect with related function

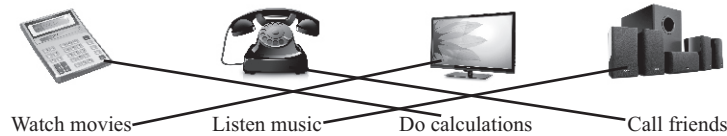

I Check whether True or False

- 1) False 2) True 3) True

II Fill the series

- 1) Processing 2) Monitor 3) Storage 4) Speaker 5) CPU 6) Output 7) Hard disk

III Write down the suitable words from the list below

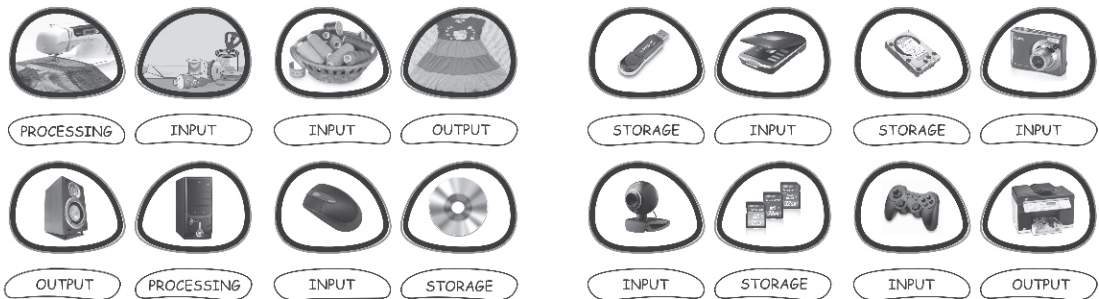

IV Connect the computer with related parts

- 1) Scanner 2) Printer 3) Speaker 4) Web camera 5) Keyboard 6) Mouse

V Name the following



Keyboard



Washing Machine



Computer



Pen drive



Mouse



Joystick

VI Answer the following

- 1) Monitor, CPU, Keyboard 2) Printer, Speaker, Headphone
3) Control processing unit 4) Hard disc, Pen drive, DVD

ITG-II

4

LAB CULTURE

I Fill in the blanks

- 1) Monitor 2) Silence 3) Dust covers 4) Clean and Neat
5) Computer table 6) Mousepad

II Tick whether Good or Bad behaviors

- 1) Good 2) Bad 3) Good 4) Good 5) Bad

III Tick the pictures with Good or Bad

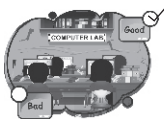

IV Mark Good or bad behaviours

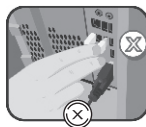

V Complete the Crossword

- 1) Computer lab
2) Mousepad
3) Clean
4) Distance

I Fill in the blanks

- 1) Spacebar 2) Numeric 3) Shift 4) Notepad

II Rearrange the steps to open Notepad

- 1) Start button 2) All Apps 3) Windows Accessories 4) Notepad

III Tick whether True or False

- 1) False 2) True 3) True 4) False 5) False

IV Identify the keys

- 1) Backspace key 2) Shift key 3) Delete key 4) Enter key

V Connect the bats with related halloween

- 1) Delete 2) Caps lock 3) Space bar 4) Enter key 5) F10

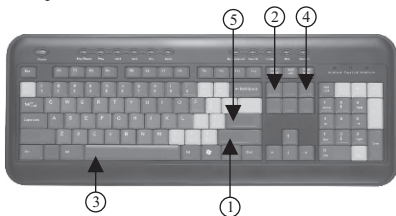
VI Keyboard Crossword**VII Answer the following**

- 1) Caps Lock Key is used to get capital letters. On pressing it, small light glows on the keyboard
- 2) On the top line of the keyboard, some keys marked as F1,F2 etc. up to F12. They are called Function keys. Each Function Key has some special task

I Connect the following with related stickers

- 1) Line tool 2) Curve tool 3) Right arrow 4) Left arrow 5) Brush 6) Diamond

II Identify and write these tools

- 1) Fill colour 2) Curve tool 3) Pencil tool 4) Line tool 5) Oval tool 6) Air brush

III Fill the steps using stickers to open Paint and save a file

- 1) Start 2) All apps 3) Windows Accessories 4) Paint 5) File 6) Save

IV Name the following

- A) Eraser B) Curve C) Fill with Color D) Oval E) Round Rectangle
F) Brush

V Tick the tools used to draw the given picture

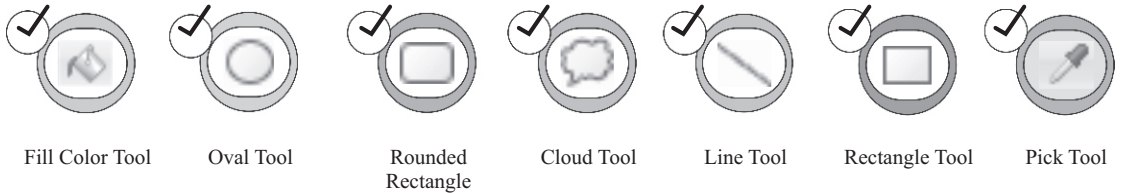

ITG-II 7 STARTING WITH TUX PAINT

I Fill in the blanks

- 1) B 2) A 3) D 4) C

II Connect with suitable balloons

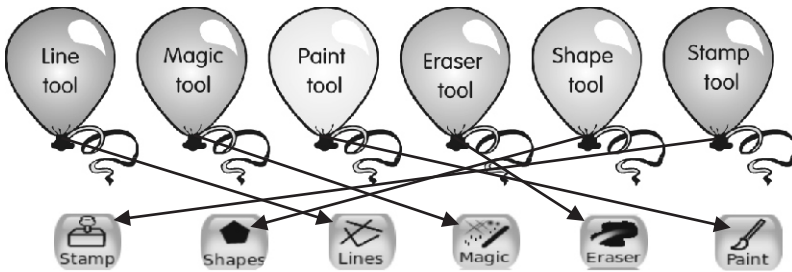

III Match the tools with shapes

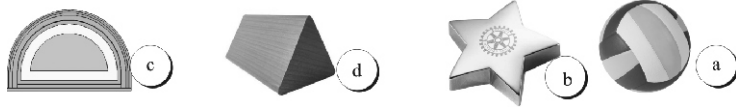

IV Match the tools with picture